

## Square Weld Nut - Piloted - 4 Projections: 2010-1

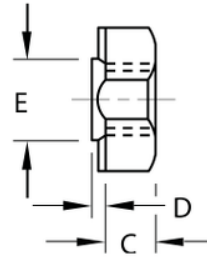

|                                  |  |
|----------------------------------|--|
| Thread Size                      | 7/16-14                                      |
| Width (in)                       | 0.750  |
| Thickness (in)                   | 0.312  |
| Pilot Height (in)                | 0.062  |
| Pilot Diameter (in)              | 0.656  |
| A (in)                           | 0.750  |
| Tol A (in)                       | +0.000 / -0.014                              |
| B Width Across Corners Min. (in) | 0.855  |
| C (in)                           | 0.312  |
| Tol C (in)                       | +0.008 / -0.008                              |
| D (in)                           | 0.062  |
| Tol D (in)                       | +0.005 / -0.005                              |
| E (in)                           | 0.656  |
| Tol E (in)                       | +0.000 / -0.007                              |
| Material                         | C1010 High-Welding Quality, Low Carbon Steel |
| Finish                           | Plain, Unless Specified                      |
| Threads                          | Unified Standard Class 2B ASME B 1.1-2003    |

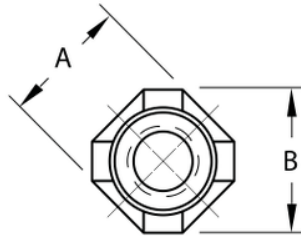

**BUCKEYE FASTENERS COMPANY**

DISTRIBUTED BY

**ADVANCE**  
COMPONENTS



advancecomponents.com

972-446-5500