

NOSE ASSEMBLY DATA SHEET

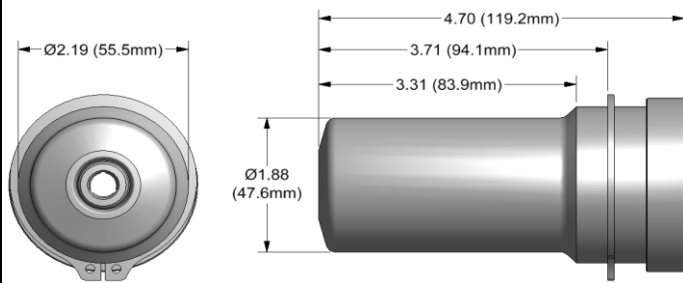

1. Ensure Piston is in full forward position.
2. Disconnect tool control cord.
3. Screw assembled Collet onto Piston until top of collet flat lines up with Adapter face of tool.
4. If Collet Lock is not in Piston groove, continue to turn 1/4 turn clockwise, or less, until lock engage groove.
5. Slide Anvil (1) over assembled Collet. Install Split Ring, Sleeve (furnished with tool) and Retaining Ring (9).

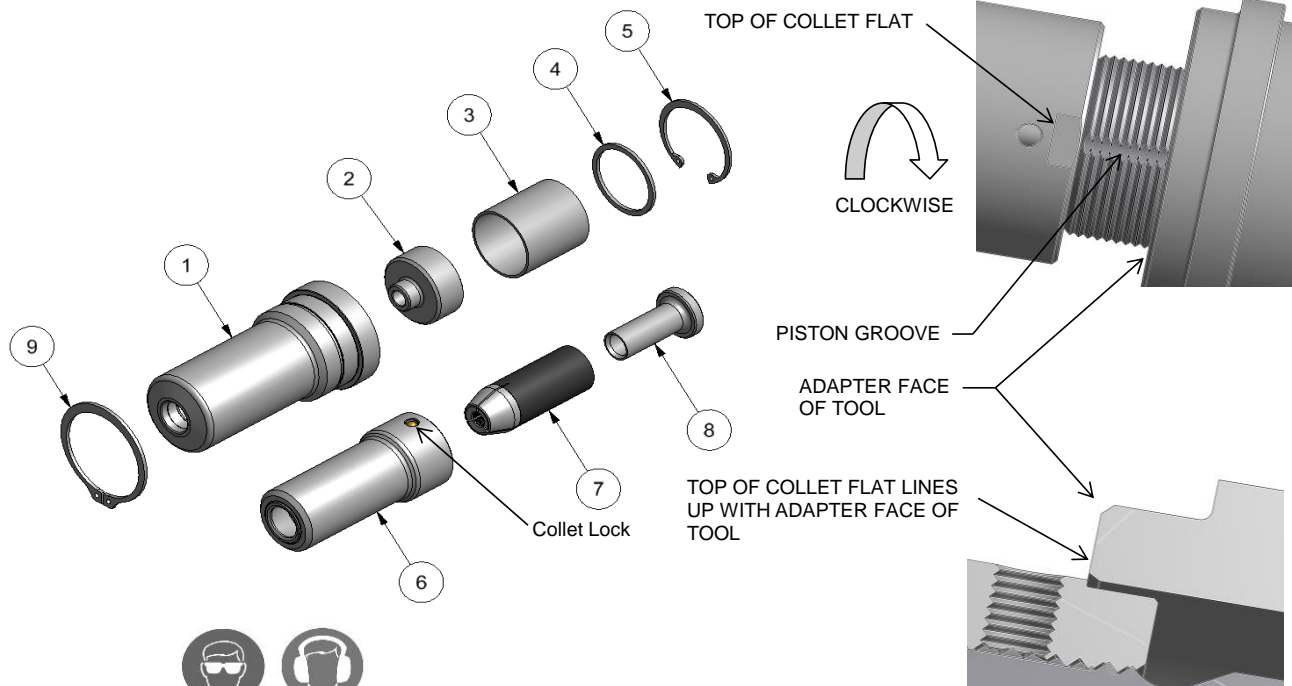

6/20 REV 7/22



DISTRIBUTED BY

GAGE BILT
MADE in USA



advancecomponents.com 972-446-5500

Type:		Fastener:	Recommended Tool: GB2624PT
Self-Releasing 1/2" Ø		BOM®	Alternate Tools: GB2624PTD
Ref. No.	Qty.	Description	BOM16-2624-37
1	1	Anvil	11633
2	1	Ejector	81621
3	1	Spacer Tube	61618
4	1	Spacer	61616
5	1	Retaining Ring	61617
6	1	Collet Assy.	21618
7	4	Super Grip Jaw Assy.	31614-CS
8	1	Sleeve	61619
9	1	Retaining Ring	401027

BOM® IS A REGISTERED TRADEMARK OF HOWMET AEROSPACE.