

Right Angle No Projection - Spaded Weld Screw

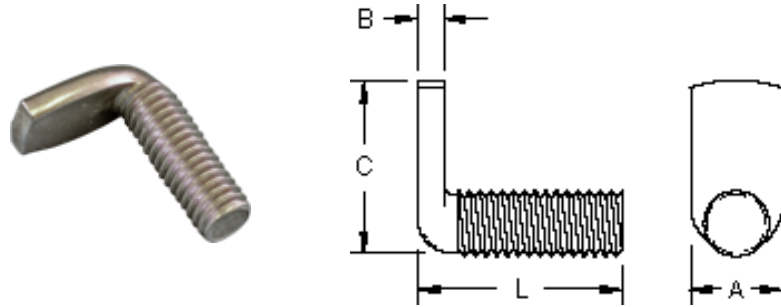

DISTRIBUTED BY

ADVANCE COMPONENTS

advancecomponents.com 972-446-5500

Product	Thread Size	Length (in)	A Ref. (in)	B (in)	Tol B (in)	C Ref. (in)	L (in)	Tol L (in)
SS 1108	#6-32	1/2	0.218	0.047	+0.005 -0.005	0.562	0.500	+0.000 -0.030
SS 1406	#8-32	3/8	0.250	0.063	+0.005 -0.005	0.625	0.375	+0.000 -0.030
SS 1408	#8-32	1/2	0.250	0.063	+0.005 -0.005	0.625	0.500	+0.000 -0.030
SS 1410	#8-32	5/8	0.250	0.063	+0.005 -0.005	0.625	0.625	+0.000 -0.030
SS 1412	#8-32	3/4	0.250	0.063	+0.005 -0.005	0.625	0.750	+0.000 -0.030
SS 1414	#8-32	7/8	0.250	0.063	+0.005 -0.005	0.625	0.875	+0.000 -0.030
SS 1416	#8-32	1	0.250	0.063	+0.005 -0.005	0.625	1.000	+0.000 -0.030
SS 1424	#8-32	1 1/2	0.250	0.063	+0.005 -0.005	0.625	1.500	+0.000 -0.060
SS 1432	#8-32	2	0.250	0.063	+0.005 -0.005	0.625	2.000	+0.000 -0.060
SS 1506	#10-24	3/8	0.312	0.063	+0.005 -0.005	0.688	0.375	+0.000 -0.030
SS 1508	#10-24	1/2	0.312	0.063	+0.005 -0.005	0.688	0.500	+0.000 -0.030
SS 1510	#10-24	5/8	0.312	0.063	+0.005 -0.005	0.688	0.625	+0.000 -0.030
SS 1512	#10-24	3/4	0.312	0.063	+0.005 -0.005	0.688	0.750	+0.000 -0.030

SS 1516	#10-24	1	0.312	0.063	+0.005 -0.005	0.688	1.000	+0.000 -0.030
SS 1520	#10-24	1 1/4	0.312	0.063	+0.005 -0.005	0.688	1.250	+0.000 -0.060
SS 1524	#10-24	1 1/2	0.312	0.063	+0.005 -0.005	0.688	1.500	+0.000 -0.060
SS 1532	#10-24	2	0.312	0.063	+0.005 -0.005	0.688	2.000	+0.000 -0.060
SS 1606	#10-32	3/8	0.343	0.063	+0.005 -0.005	0.688	0.375	+0.000 -0.030
SS 1608	#10-32	1/2	0.343	0.063	+0.005 -0.005	0.688	0.500	+0.000 -0.030
SS 1610	#10-32	5/8	0.343	0.063	+0.005 -0.005	0.688	0.625	+0.000 -0.030
SS 1612	#10-32	3/4	0.343	0.063	+0.005 -0.005	0.688	0.750	+0.000 -0.030
SS 1614	#10-32	7/8	0.343	0.063	+0.005 -0.005	0.688	0.875	+0.000 -0.030
SS 1616	#10-32	1	0.343	0.063	+0.005 -0.005	0.688	1.000	+0.000 -0.030
SS 1620	#10-32	1 1/4	0.343	0.063	+0.005 -0.005	0.688	1.250	+0.000 -0.060
SS 2108	1/4-20	1/2	0.375	0.094	+0.005 -0.005	0.750	0.500	+0.000 -0.030
SS 2110	1/4-20	5/8	0.375	0.094	+0.005 -0.005	0.750	0.625	+0.000 -0.030
SS 2112	1/4-20	3/4	0.375	0.094	+0.005 -0.005	0.750	0.750	+0.000 -0.030
SS 2114	1/4-20	7/8	0.375	0.094	+0.005 -0.005	0.750	0.875	+0.000 -0.030
SS 2116	1/4-20	1	0.375	0.094	+0.005 -0.005	0.750	1.000	+0.000 -0.030
SS 2120	1/4-20	1 1/4	0.375	0.094	+0.005 -0.005	0.750	1.250	+0.000 -0.060
SS 2124	1/4-20	1 1/2	0.375	0.094	+0.005 -0.005	0.750	1.500	+0.000 -0.060
SS 2128	1/4-20	1 3/4	0.375	0.094	+0.005 -0.005	0.750	1.750	+0.000 -0.060
SS 2132	1/4-20	2	0.375	0.094	+0.005 -0.005	0.750	2.000	+0.000 -0.060
SS 2710	5/16-18	5/8	0.437	0.125	+0.005 -0.005	0.875	0.625	+0.000 -0.030
SS 2712	5/16-18	3/4	0.437	0.125	+0.005 -0.005	0.875	0.750	+0.000 -0.030

SS 2714	5/16-18	7/8	0.437	0.125	+0.005 -0.005	0.875	0.875	+0.000 -0.030
SS 2716	5/16-18	1	0.437	0.125	+0.005 -0.005	0.875	1.000	+0.000 -0.030
SS 2720	5/16-18	1 1/4	0.437	0.125	+0.005 -0.005	0.875	1.250	+0.000 -0.060
SS 2724	5/16-18	1 1/2	0.437	0.125	+0.005 -0.005	0.875	1.500	+0.000 -0.060
SS 2732	5/16-18	2	0.437	0.125	+0.005 -0.005	0.875	2.000	+0.000 -0.060
SS 3316	3/8-16	1	0.531	0.156	+0.005 -0.005	1.000	1.000	+0.000 -0.030
SS 3320	3/8-16	1 1/4	0.531	0.156	+0.005 -0.005	1.000	1.250	+0.000 -0.060
SS 3324	3/8-16	1 1/2	0.531	0.156	+0.005 -0.005	1.000	1.500	+0.000 -0.060

Material: C1010 High-Welding Quality, Low Carbon Steel

Finish: Plain, Unless Specified

Threads: Unified Standard Class 2A ASME B 1.1-2003

3 Projections On Top of Head

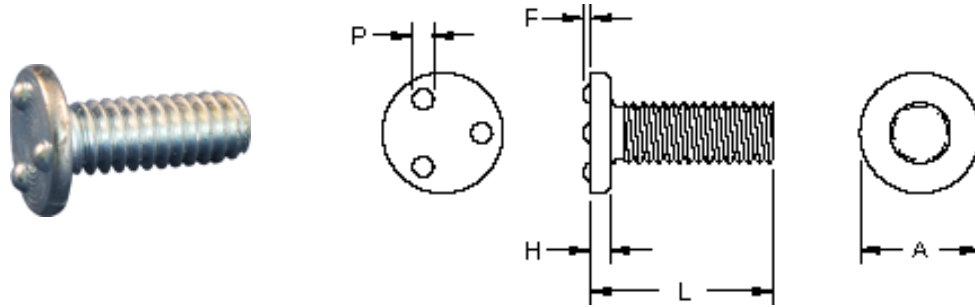

DISTRIBUTED BY

ADVANCE

COMPONENTS

advancecomponents.com 972-446-5500

Product	Thread Size	Length (mm)	Head Diameter (mm)	A (mm)	Tol A (mm)	F (mm)	Tol F (mm)	H (mm)	Tol H (mm)	L (mm)	Tol L (mm)	P (mm)	Tol P (mm)
GWM 03508	M3.5 X 0.6-6g	8.00	7.0	7.00	+0.25 -0.25	0.53	+0.05 -0.05	1.10	+0.13 -0.13	8.00	+0.00 -0.80	1.40	+0.13 -0.13
GWM 03510	M3.5 X 0.6-6g	10.00	7.0	7.00	+0.25 -0.25	0.53	+0.05 -0.05	1.10	+0.13 -0.13	10.00	+0.00 -0.80	1.40	+0.13 -0.13
GWM 03516	M3.5 X 0.6-6g	16.00	7.0	7.00	+0.25 -0.25	0.53	+0.05 -0.05	1.10	+0.13 -0.13	16.00	+0.00 -0.80	1.40	+0.13 -0.13
GWM 03525	M3.5 X 0.6-6g	25.00	7.0	7.00	+0.25 -0.25	0.53	+0.05 -0.05	1.10	+0.13 -0.13	25.00	+0.00 -0.80	1.40	+0.13 -0.13
GWM 04006	M4 X 0.7-6g	6.00	8.0	8.00	+0.25 -0.25	0.64	+0.05 -0.05	1.20	+0.13 -0.13	6.00	+0.00 -0.80	1.78	+0.13 -0.13
GWM 04008	M4 X 0.7-6g	8.00	8.0	8.00	+0.25 -0.25	0.64	+0.05 -0.05	1.20	+0.13 -0.13	8.00	+0.00 -0.80	1.78	+0.13 -0.13
GWM 04010	M4 X 0.7-6g	10.00	8.0	8.00	+0.25 -0.25	0.64	+0.05 -0.05	1.20	+0.13 -0.13	10.00	+0.00 -0.80	1.78	+0.13 -0.13
GWM 04012	M4 X 0.7-6g	12.00	8.0	8.00	+0.25 -0.25	0.64	+0.05 -0.05	1.20	+0.13 -0.13	12.00	+0.00 -0.80	1.78	+0.13 -0.13
GWM 04014	M4 X 0.7-6g	14.00	8.0	8.00	+0.25 -0.25	0.64	+0.05 -0.05	1.20	+0.13 -0.13	14.00	+0.00 -0.80	1.78	+0.13 -0.13
GWM 04016	M4 X 0.7-6g	16.00	8.0	8.00	+0.25 -0.25	0.64	+0.05 -0.05	1.20	+0.13 -0.13	16.00	+0.00 -0.80	1.78	+0.13 -0.13
GWM 04020	M4 X 0.7-6g	20.00	8.0	8.00	+0.25 -0.25	0.64	+0.05 -0.05	1.20	+0.13 -0.13	20.00	+0.00 -0.80	1.78	+0.13 -0.13
GWM 04025	M4 X 0.7-6g	25.00	8.0	8.00	+0.25 -0.25	0.64	+0.05 -0.05	1.20	+0.13 -0.13	25.00	+0.00 -0.80	1.78	+0.13 -0.13
GWM 04030	M4 X 0.7-6g	30.00	8.0	8.00	+0.25 -0.25	0.64	+0.05 -0.05	1.20	+0.13 -0.13	30.00	+0.00 -1.60	1.78	+0.13 -0.13

GWM 05010	M5 X 0.8-6g	10.00	10.0	10.00	+0.25 -0.25	0.81	+0.05 -0.05	1.60	+0.13 -0.13	10.00	+0.00 -0.80	2.13	+0.13 -0.13
GWM 05012	M5 X 0.8-6g	12.00	10.0	10.00	+0.25 -0.25	0.81	+0.05 -0.05	1.60	+0.13 -0.13	12.00	+0.00 -0.80	2.13	+0.13 -0.13
GWM 05014	M5 X 0.8-6g	14.00	10.0	10.00	+0.25 -0.25	0.81	+0.05 -0.05	1.60	+0.13 -0.13	14.00	+0.00 -0.80	2.13	+0.13 -0.13
GWM 05016	M5 X 0.8-6g	16.00	10.0	10.00	+0.25 -0.25	0.81	+0.05 -0.05	1.60	+0.13 -0.13	16.00	+0.00 -0.80	2.13	+0.13 -0.13
GWM 05020	M5 X 0.8-6g	20.00	10.0	10.00	+0.25 -0.25	0.81	+0.05 -0.05	1.60	+0.13 -0.13	20.00	+0.00 -0.80	2.13	+0.13 -0.13
GWM 05025	M5 X 0.8-6g	25.00	10.0	10.00	+0.25 -0.25	0.81	+0.05 -0.05	1.60	+0.13 -0.13	25.00	+0.00 -0.80	2.13	+0.13 -0.13
GWM 05030	M5 X 0.8-6g	30.00	10.0	10.00	+0.25 -0.25	0.81	+0.05 -0.05	1.60	+0.13 -0.13	30.00	+0.00 -1.60	2.13	+0.13 -0.13
GWM 05035	M5 X 0.8-6g	35.00	10.0	10.00	+0.25 -0.25	0.81	+0.05 -0.05	1.60	+0.13 -0.13	35.00	+0.00 -1.60	2.13	+0.13 -0.13
GWM 05045	M5 X 0.8-6g	45.00	10.0	10.00	+0.25 -0.25	0.81	+0.05 -0.05	1.60	+0.13 -0.13	45.00	+0.00 -1.60	2.13	+0.13 -0.13
GWM 06010	M6 X 1.0-6g	10.00	12.0	12.00	+0.30 -0.30	1.02	+0.05 -0.05	1.90	+0.13 -0.13	10.00	+0.00 -0.80	2.54	+0.13 -0.13
GWM 06012	M6 X 1.0-6g	12.00	12.0	12.00	+0.30 -0.30	1.02	+0.05 -0.05	1.90	+0.13 -0.13	12.00	+0.00 -0.80	2.54	+0.13 -0.13
GWM 06014	M6 X 1.0-6g	14.00	12.0	12.00	+0.30 -0.30	1.02	+0.05 -0.05	1.90	+0.13 -0.13	14.00	+0.00 -0.80	2.54	+0.13 -0.13
GWM 06016	M6 X 1.0-6g	16.00	12.0	12.00	+0.30 -0.30	1.02	+0.05 -0.05	1.90	+0.13 -0.13	16.00	+0.00 -0.80	2.54	+0.13 -0.13
GWM 06020	M6 X 1.0-6g	20.00	12.0	12.00	+0.30 -0.30	1.02	+0.05 -0.05	1.90	+0.13 -0.13	20.00	+0.00 -0.80	2.54	+0.13 -0.13
GWM 06025	M6 X 1.0-6g	25.00	12.0	12.00	+0.30 -0.30	1.02	+0.05 -0.05	1.90	+0.13 -0.13	25.00	+0.00 -0.80	2.54	+0.13 -0.13
GWM 06030	M6 X 1.0-6g	30.00	12.0	12.00	+0.30 -0.30	1.02	+0.05 -0.05	1.90	+0.13 -0.13	30.00	+0.00 -1.60	2.54	+0.13 -0.13
GWM 06035	M6 X 1.0-6g	35.00	12.0	12.00	+0.30 -0.30	1.02	+0.05 -0.05	1.90	+0.13 -0.13	35.00	+0.00 -1.60	2.54	+0.13 -0.13
GWM 06040	M6 X 1.0-6g	40.00	12.0	12.00	+0.30 -0.30	1.02	+0.05 -0.05	1.90	+0.13 -0.13	40.00	+0.00 -1.60	2.54	+0.13 -0.13
GWM 06045	M6 X 1.0-6g	45.00	12.0	12.00	+0.30 -0.30	1.02	+0.05 -0.05	1.90	+0.13 -0.13	45.00	+0.00 -1.60	2.54	+0.13 -0.13
GWM 08016	M8 X 1.25-6g	16.00	16.0	16.00	+0.30 -0.30	1.20	+0.05 -0.05	2.50	+0.13 -0.13	16.00	+0.00 -0.80	3.10	+0.13 -0.13
GWM 08020	M8 X 1.25-6g	20.00	16.0	16.00	+0.30 -0.30	1.20	+0.05 -0.05	2.50	+0.13 -0.13	20.00	+0.00 -0.80	3.10	+0.13 -0.13
GWM 08025	M8 X 1.25-6g	25.00	16.0	16.00	+0.30 -0.30	1.20	+0.05 -0.05	2.50	+0.13 -0.13	25.00	+0.00 -0.80	3.10	+0.13 -0.13

GWM 08030	M8 X 1.25-6g	30.00	16.0	16.00	+0.30 -0.30	1.20	+0.05 -0.05	2.50	+0.13 -0.13	30.00	+0.00 -1.60	3.10	+0.13 -0.13
GWM 08035	M8 X 1.25-6g	35.00	16.0	16.00	+0.30 -0.30	1.20	+0.05 -0.05	2.50	+0.13 -0.13	35.00	+0.00 -1.60	3.10	+0.13 -0.13
GWM 08040	M8 X 1.25-6g	40.00	16.0	16.00	+0.30 -0.30	1.20	+0.05 -0.05	2.50	+0.13 -0.13	40.00	+0.00 -1.60	3.10	+0.13 -0.13
GWM 08045	M8 X 1.25-6g	45.00	16.0	16.00	+0.30 -0.30	1.20	+0.05 -0.05	2.50	+0.13 -0.13	45.00	+0.00 -1.60	3.10	+0.13 -0.13
GWM 10020	M10 X 1.5-6g	20.00	20.0	20.00	+0.40 -0.40	1.40	+0.05 -0.05	3.10	+0.13 -0.13	20.00	+0.00 -0.80	3.56	+0.13 -0.13
GWM 10025	M10 X 1.5-6g	25.00	20.0	20.00	+0.40 -0.40	1.40	+0.05 -0.05	3.10	+0.13 -0.13	25.00	+0.00 -0.80	3.56	+0.13 -0.13
GWM 10035	M10 X 1.5-6g	35.00	20.0	20.00	+0.40 -0.40	1.40	+0.05 -0.05	3.10	+0.13 -0.13	35.00	+0.00 -1.60	3.56	+0.13 -0.13
GWM 10040	M10 X 1.5-6g	40.00	20.0	20.00	+0.40 -0.40	1.40	+0.05 -0.05	3.10	+0.13 -0.13	40.00	+0.00 -1.60	3.56	+0.13 -0.13
GWM 10045	M10 X 1.5-6g	45.00	20.0	20.00	+0.40 -0.40	1.40	+0.05 -0.05	3.10	+0.13 -0.13	45.00	+0.00 -1.60	3.56	+0.13 -0.13
GWM 10055	M10 X 1.5-6g	55.00	20.0	20.00	+0.40 -0.40	1.40	+0.05 -0.05	3.10	+0.13 -0.13	55.00	+0.00 -2.30	3.56	+0.13 -0.13

Material: C1010 High-Welding Quality, Low Carbon Steel

Finish: Plain, Unless Specified

Threads: ASME B 1.13M-2005